

Loading Labels

Purpose

This guide will show how to load labels properly in the Sci-Print VX2/VXL. Please follow the instructions below. For further assistance, please contact Scinomix Service at 314-298-9800 ext. 208.

Who Should Use This Troubleshooting Guide?

End user

Instructions

1. Load the labels, making sure that you hold the roll together as you position it over the spindle. Make sure the print head is open by turning the green knob 90 degrees counterclockwise.



2. Feed the labels through the print head, making sure they are positioned under the red adjustable guide and through the red gap sensor.



3. Thread the labels behind the peel plate, making sure they go behind the roller, not between the roller and the blow tube.

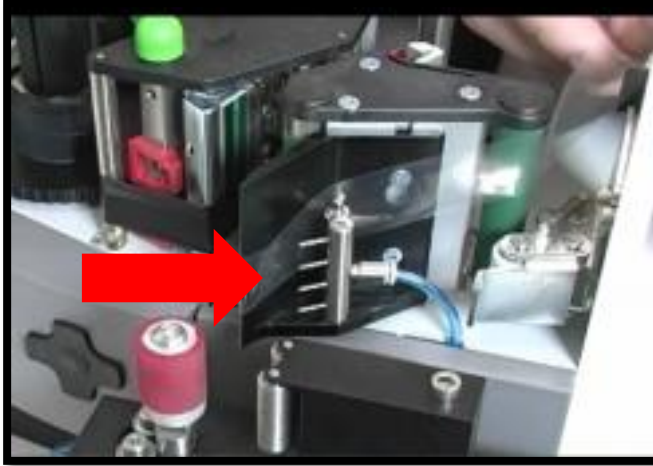

4. Insert the label liner behind one of the retaining pegs on the take up reel. Turn the take up reel counterclockwise to wind the labels through the system.



5. Wind the green knob on the spindle counterclockwise to expand the spindle (this helps release the used labels from the spindle the next time they need to be changed)



6. After winding a few labels through the printer, making sure they move freely, close the pinch roller at the front of the machine, and then close the head.



7. To thread the labels through the tensioner, push back on the rear most roller to open a gap between the two rollers and drop the labels into the gap.



Version Number	Change	Date Effective	Approved by:
A	New		

TS-1025
8/26/2015

Scinomix, Inc.